

## Les volets coulissants aluminium avec rail aluminium fixation au plafond

Outillage.....	page 2
Fixation du rail supérieur.....	page 3
- volets 1 vantail ou 2 vantaux repliables.....	page 3
- volets 2, 3 ou 4 vantaux.....	page 4
Fixation des guidages bas.....	page 5
- avec patins seuls.....	page 5
- avec patins sur équerres.....	page 5
- avec cornière seule.....	page 6
- avec cornière sur équerres.....	page 7
Mise en place des panneaux.....	page 9
- volets 1 vantail ou 2 vantaux repliables.....	page 9
- volets 2, 3 ou 4 vantaux.....	page 9
Pose du bandeau.....	page 10
Pose de la condamnation.....	page 11
- volets 1 vantail ou 2 vantaux repliables.....	page 11
- volets 2, 3 ou 4 vantaux.....	page 11

# Outillage nécessaire



# Fixation du rail supérieur

Volets 1 vantail ou  
2 vantaux repliables

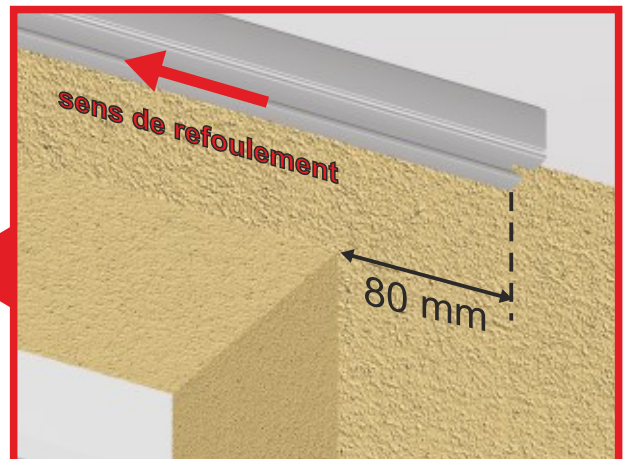
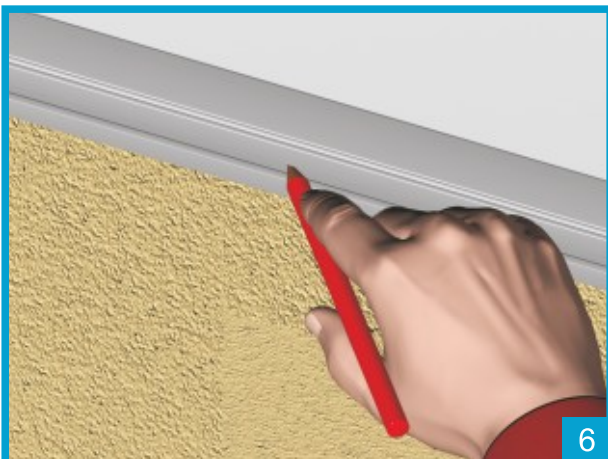
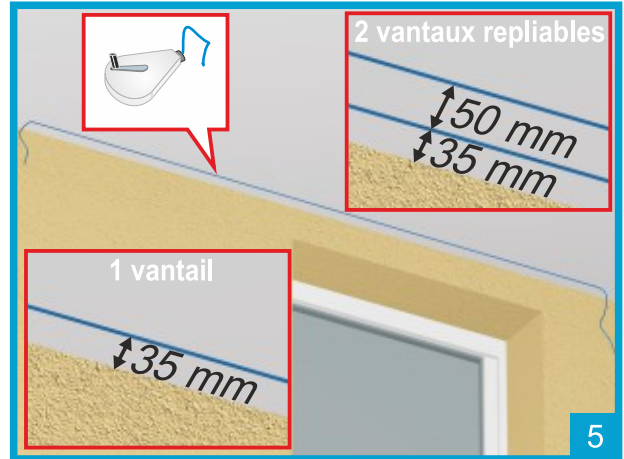
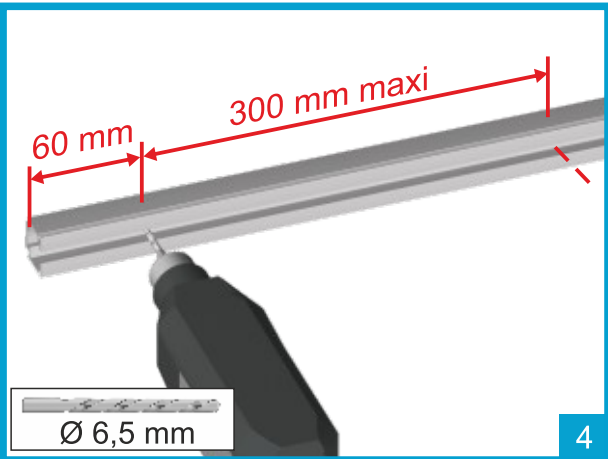
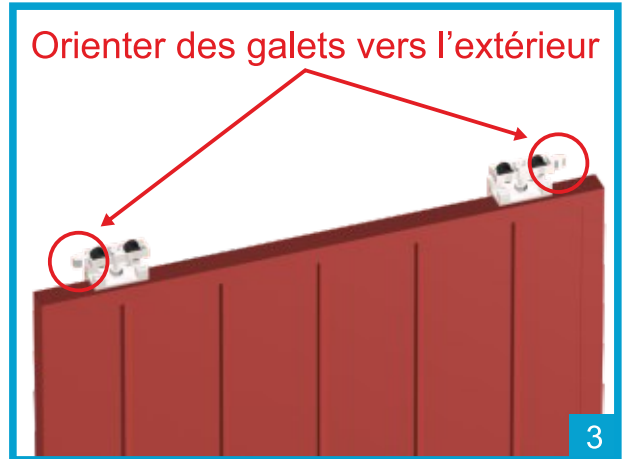
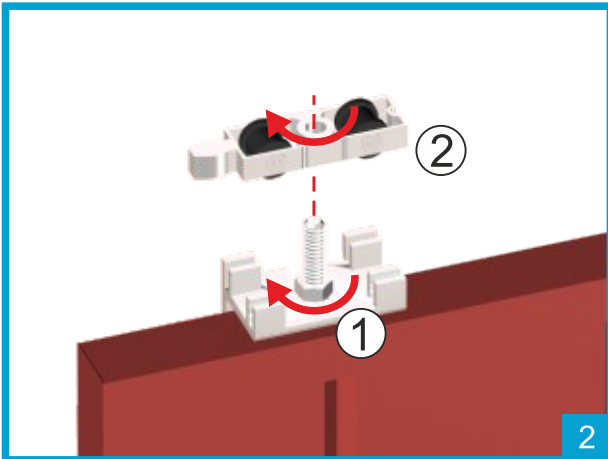
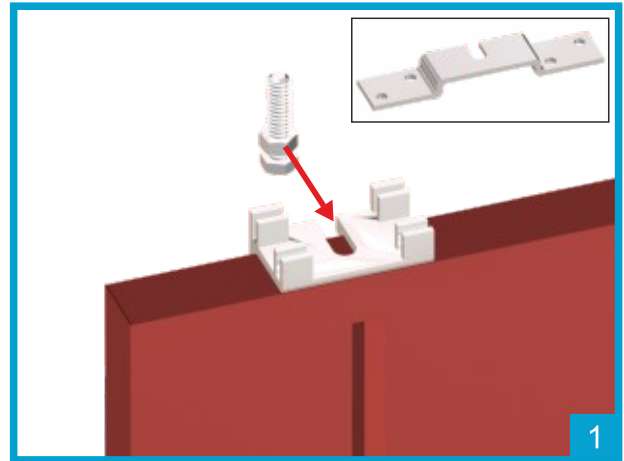

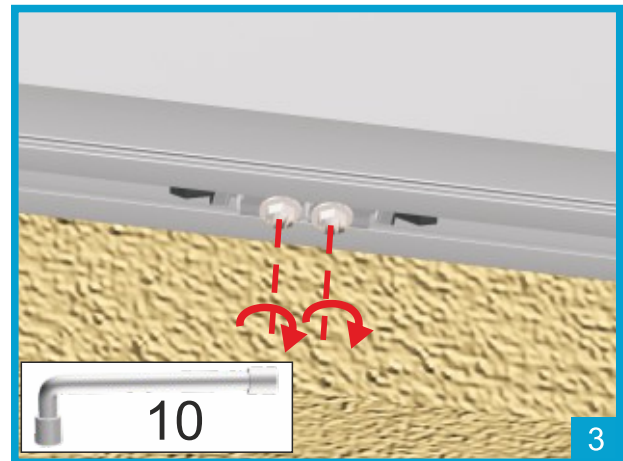
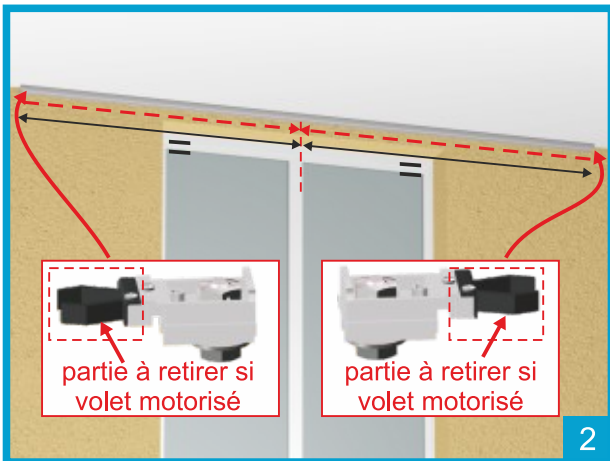
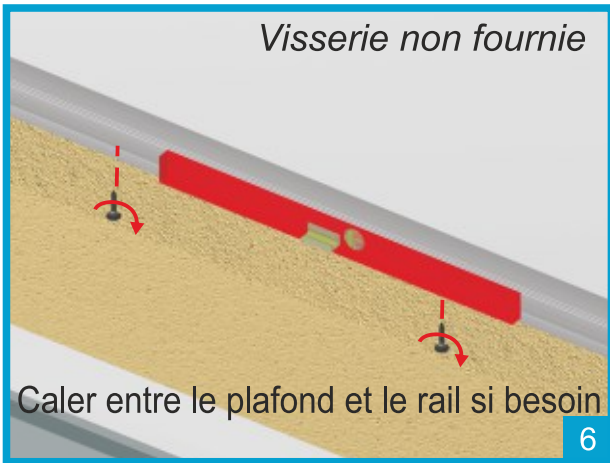



# Fixation des guidages bas

Avec patins seuls

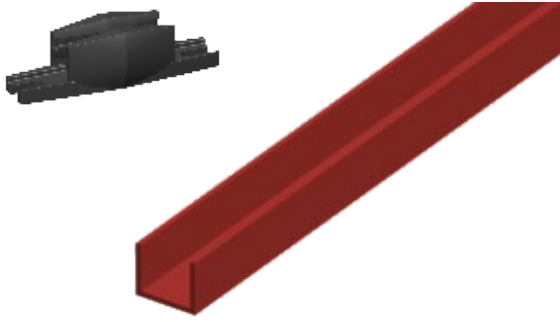

Pour vantaux simples

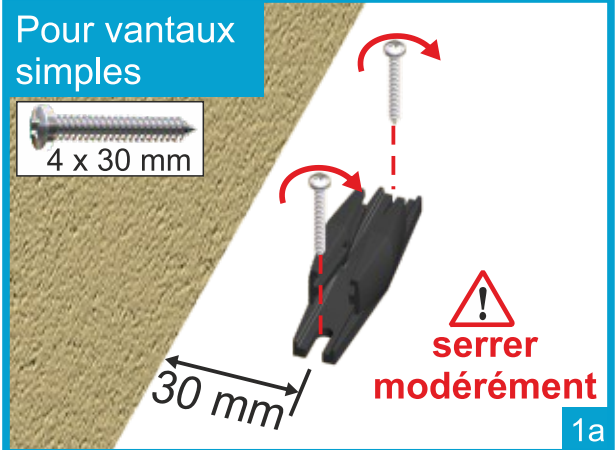

1a

Pour vantaux repliables

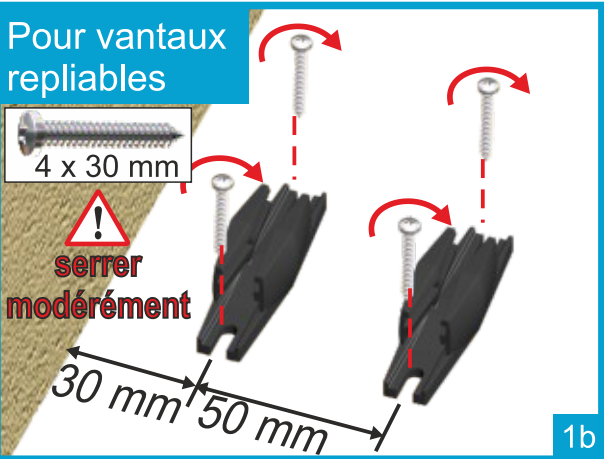
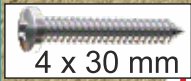

1b

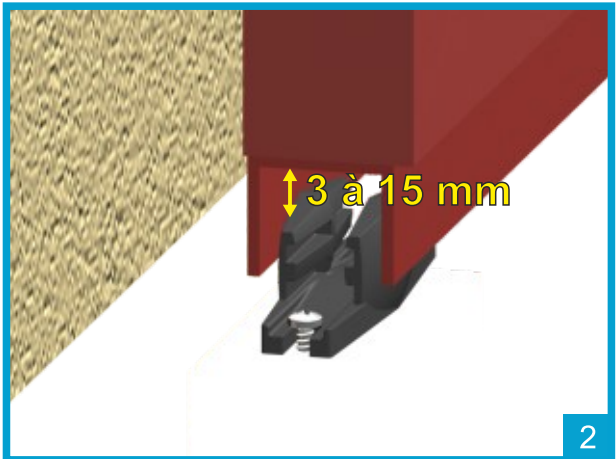

2

Avec patins sur équerres

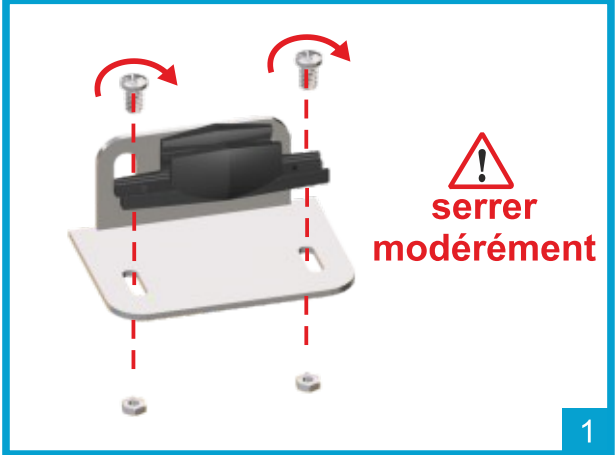
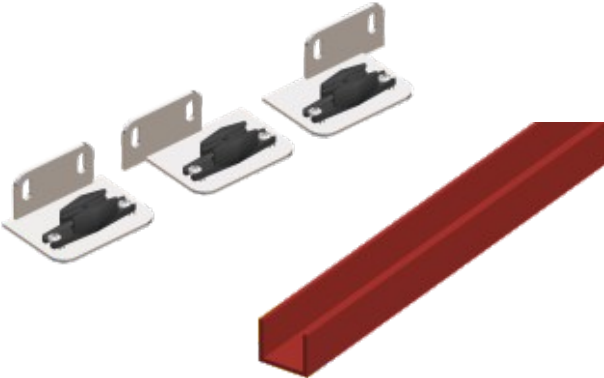

1

Pour vantaux simples

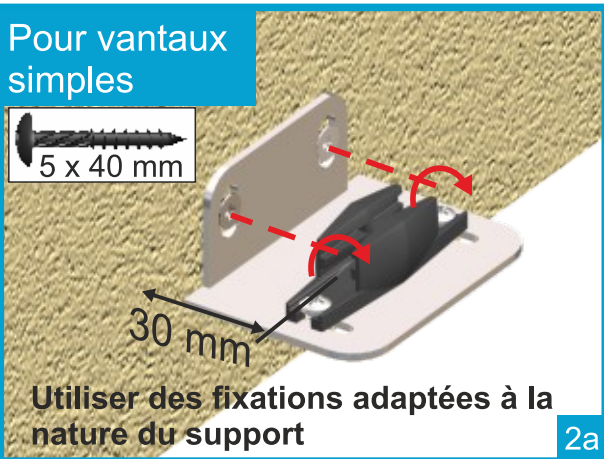
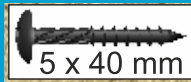

2a

Pour vantaux repliables

Utiliser des fixations adaptées à la nature du support

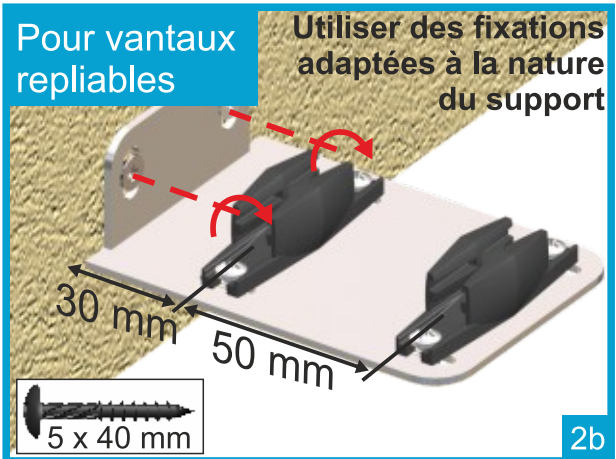

2b

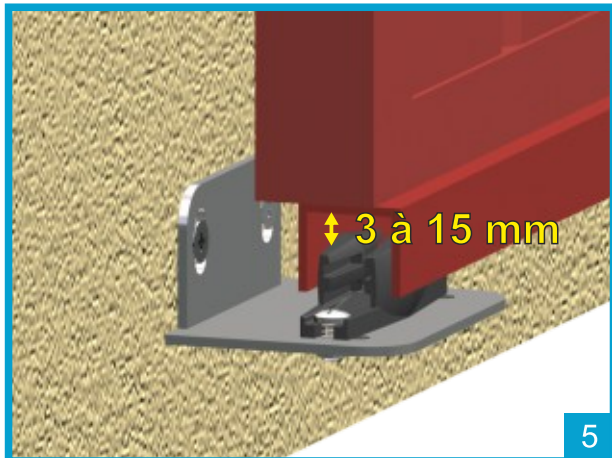
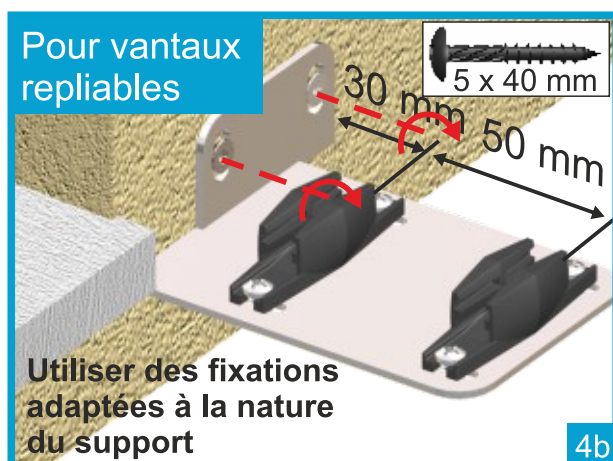
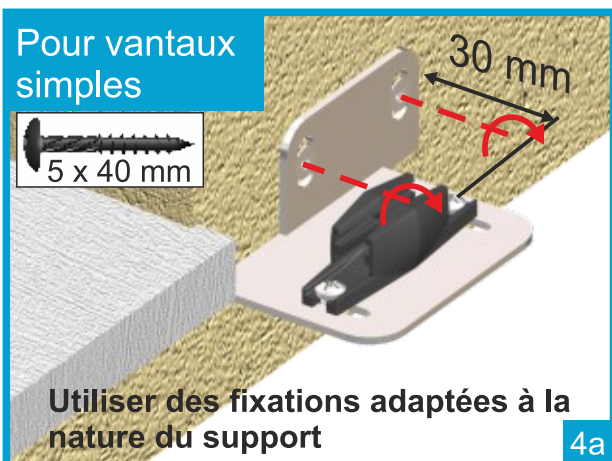
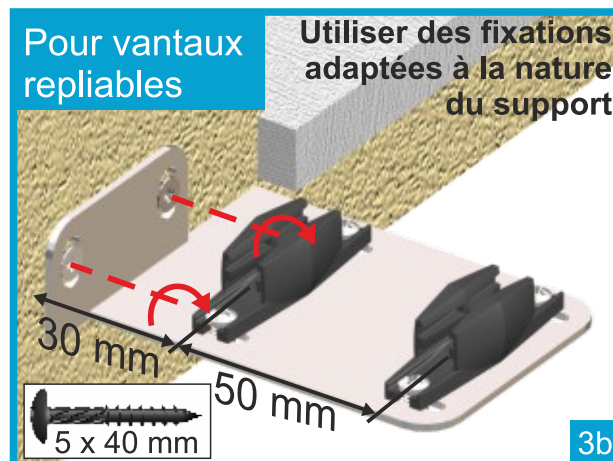
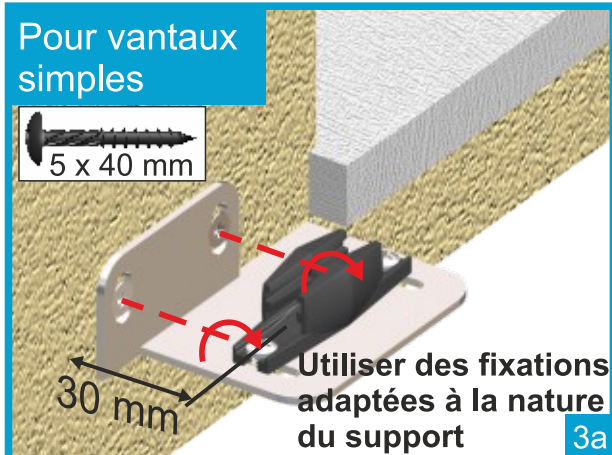

Avec cornière seule

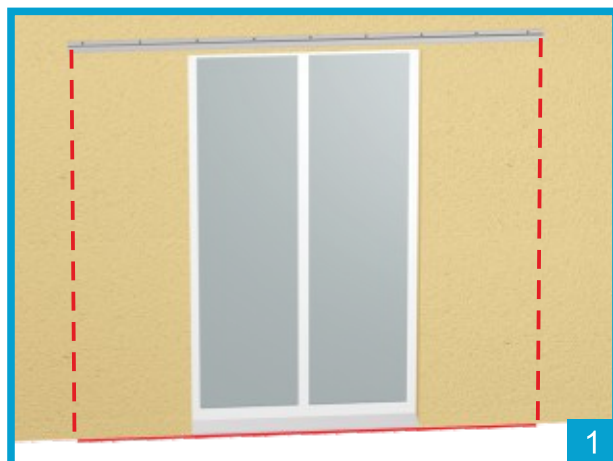
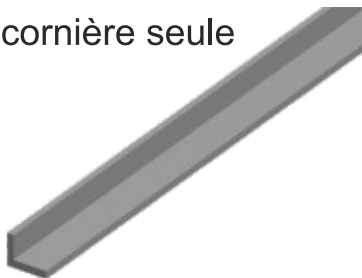



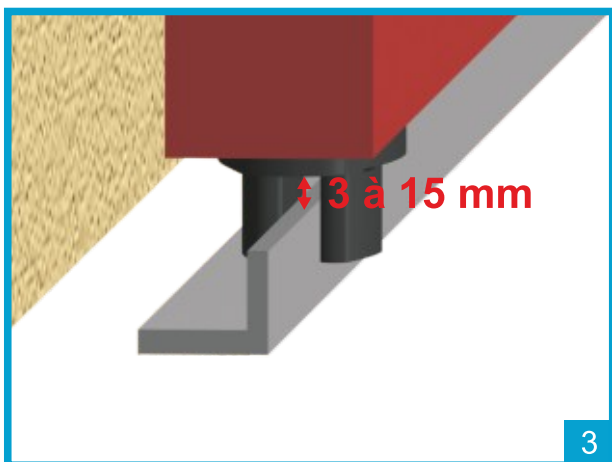
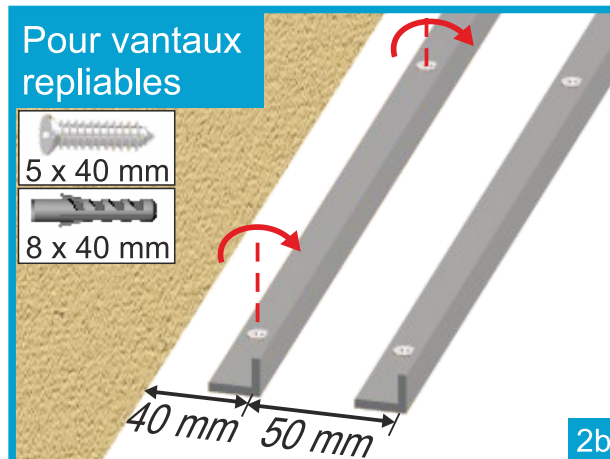
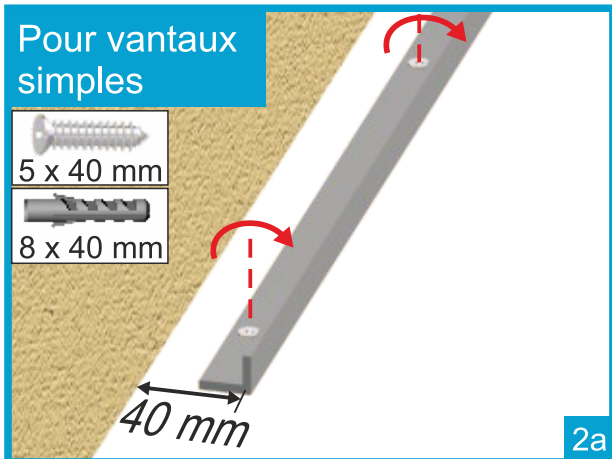

Avec cornière sur équerres

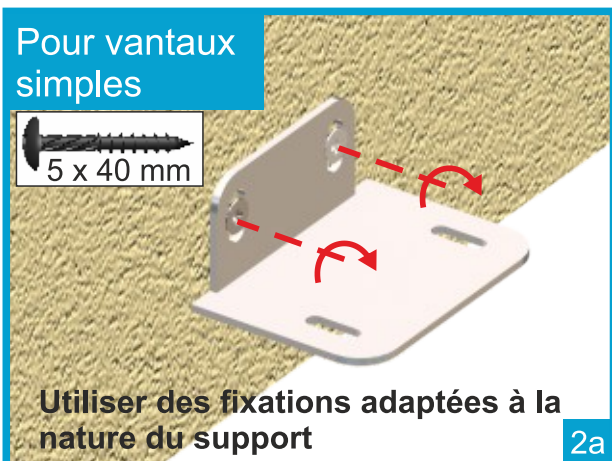
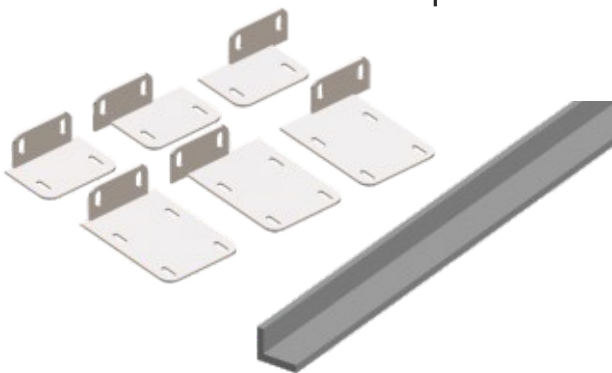

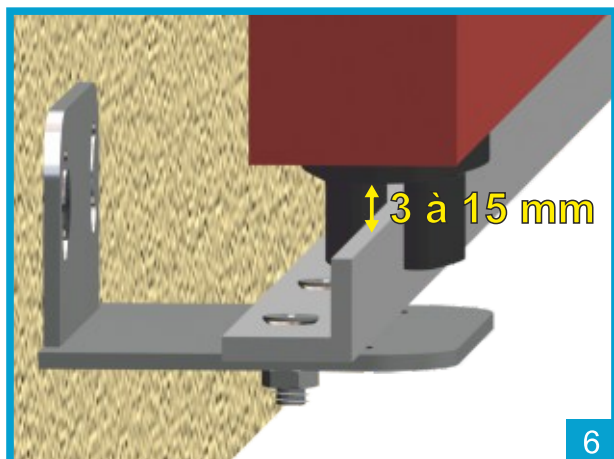
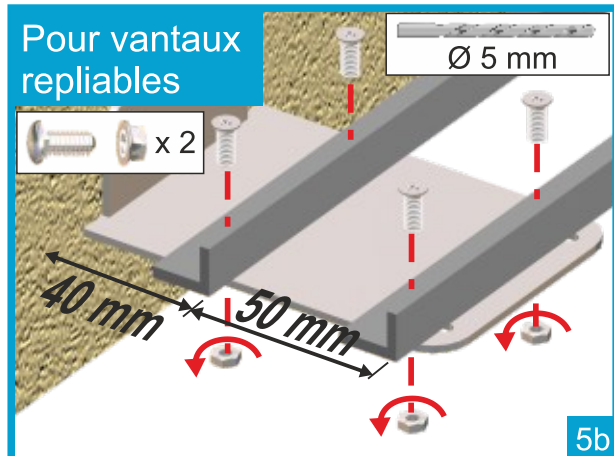
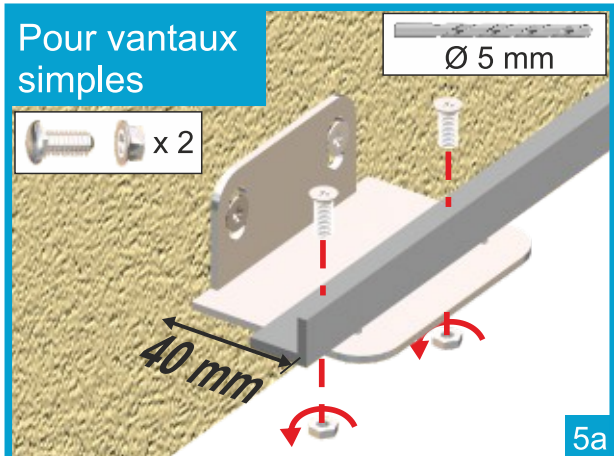
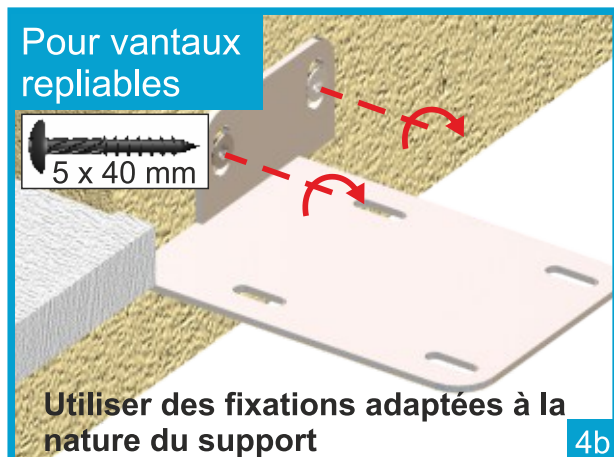
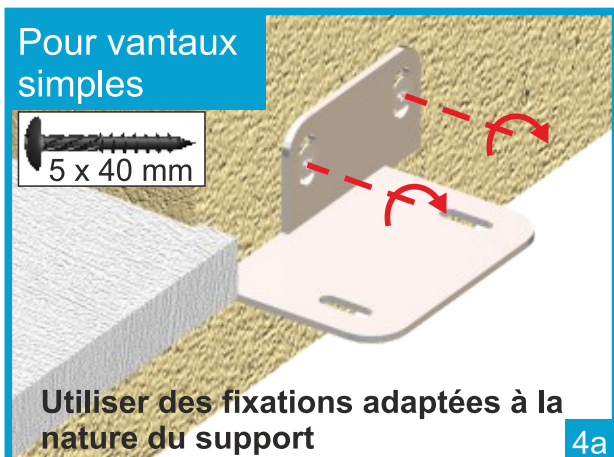
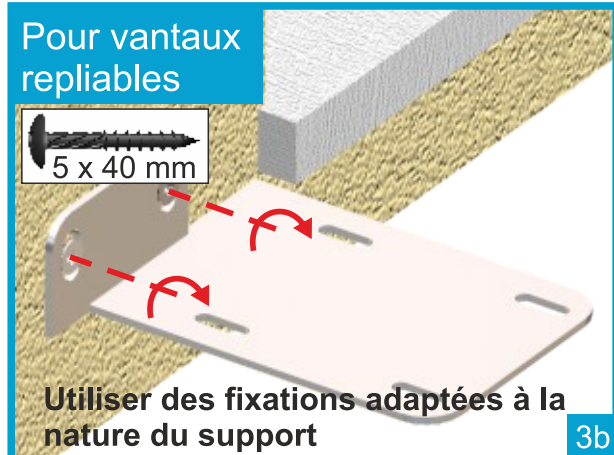
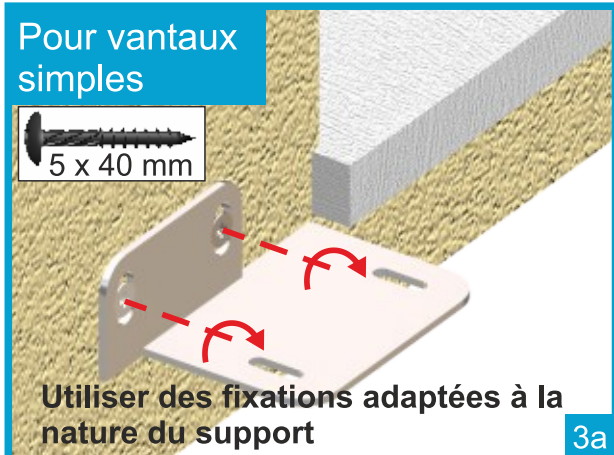



### Configuration pour 1 vantail

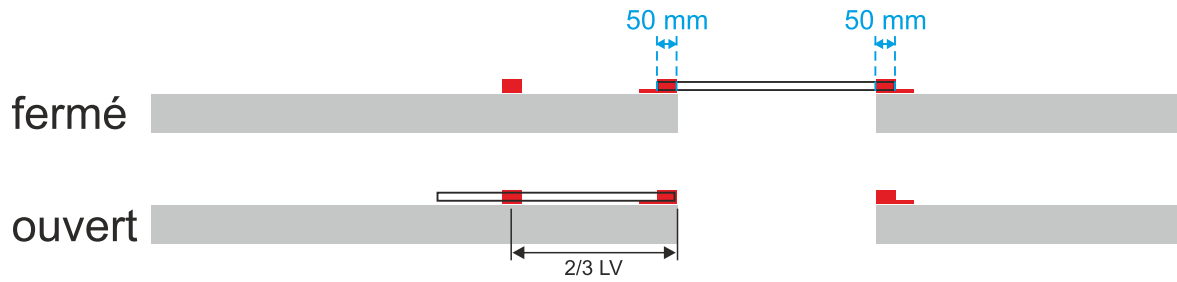

### Configuration pour 2 vantaux

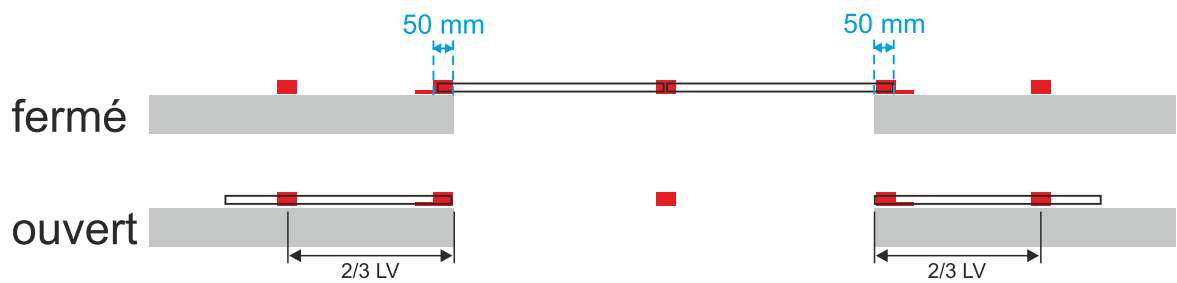

### Configuration pour 2 vantaux repliables

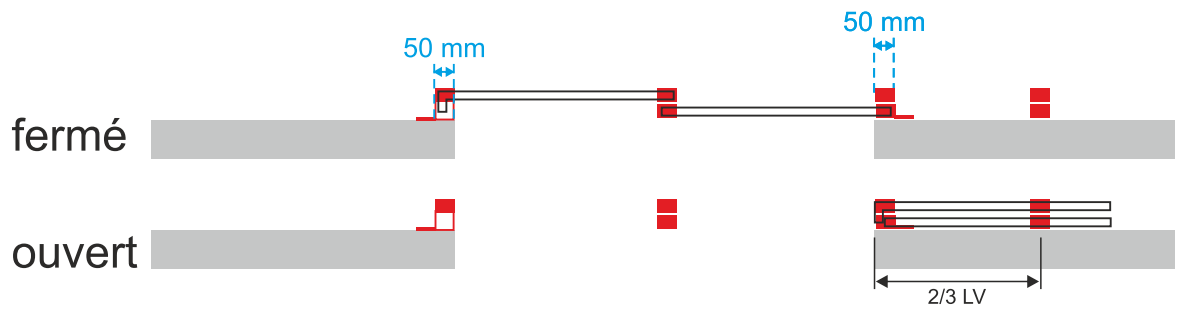

### Configuration pour 4 vantaux

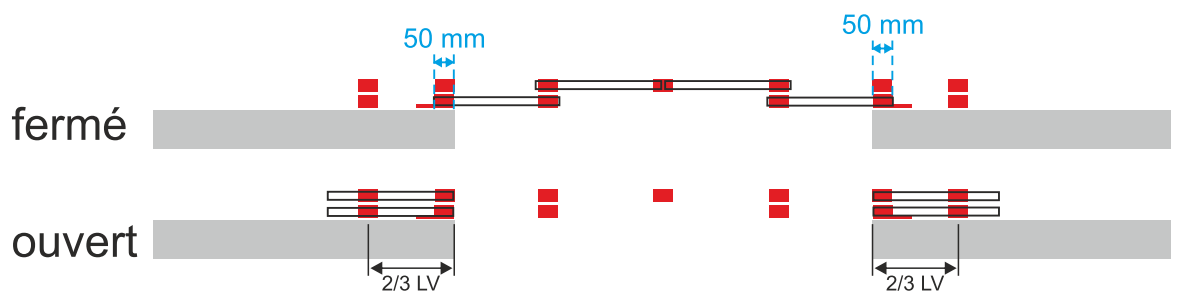

# Mise en place des panneaux

Volets 1 vantail ou  
2 vantaux repliables

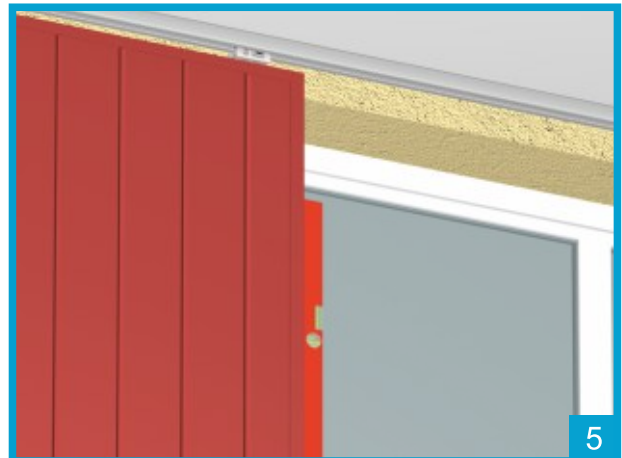
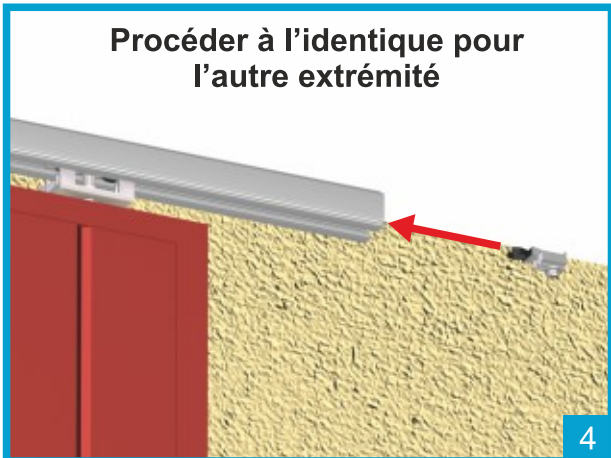
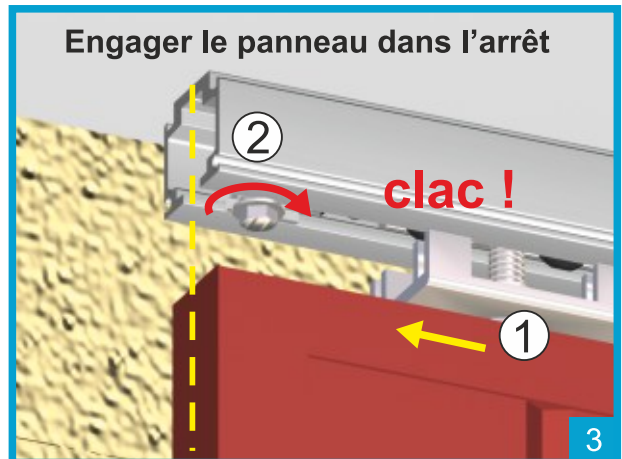
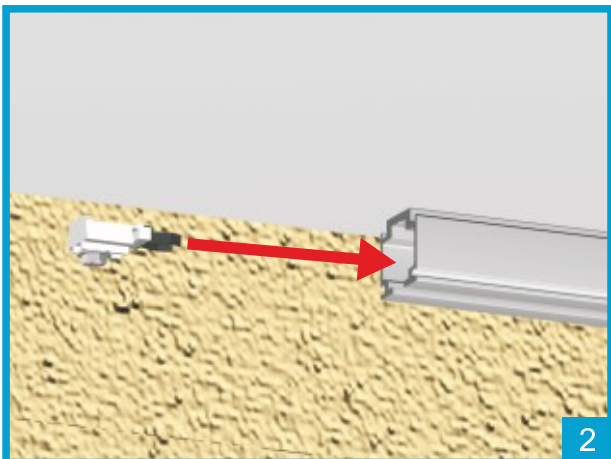
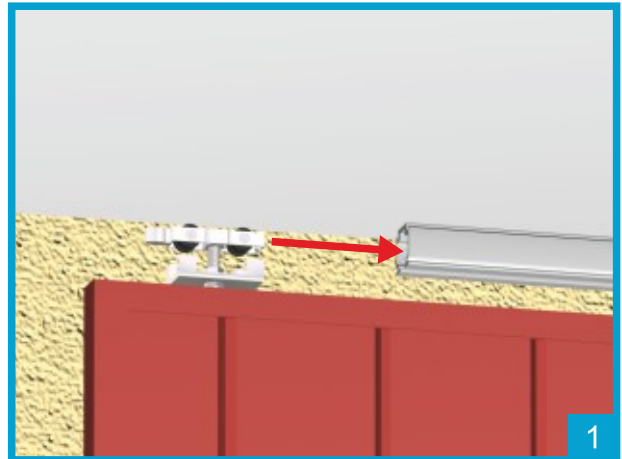

Volets 2, 3 ou 4 vantaux

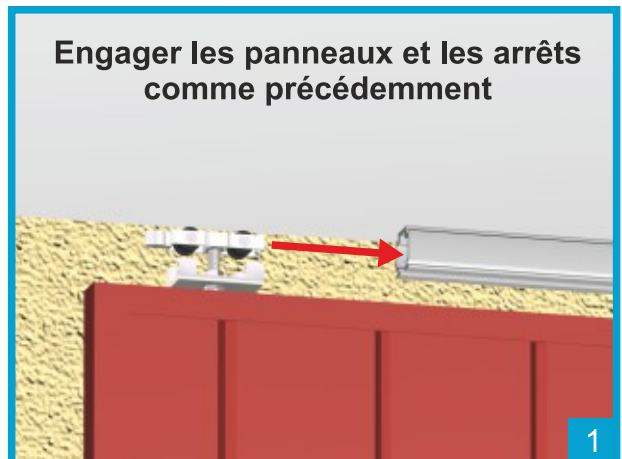

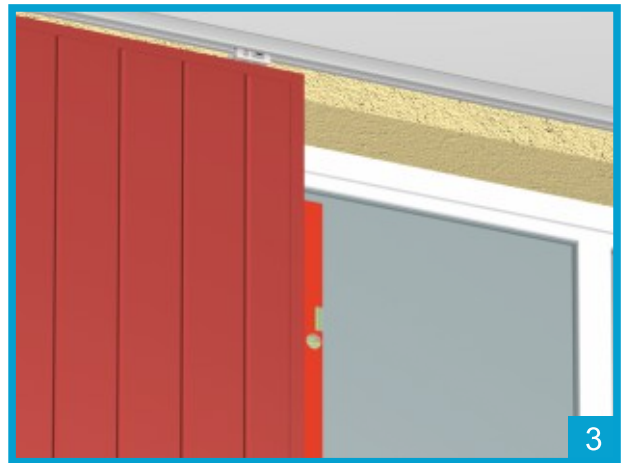
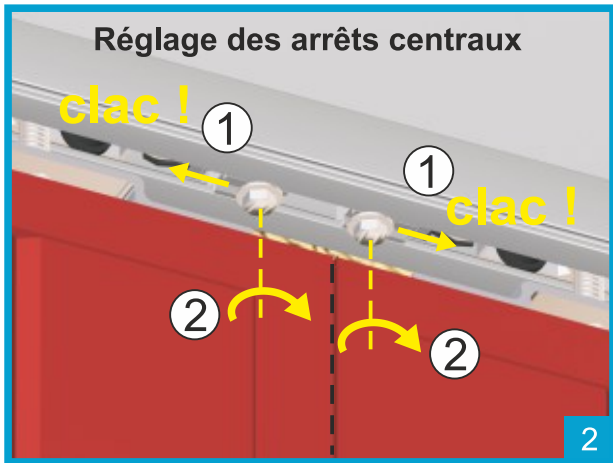

## Pose du bandeau

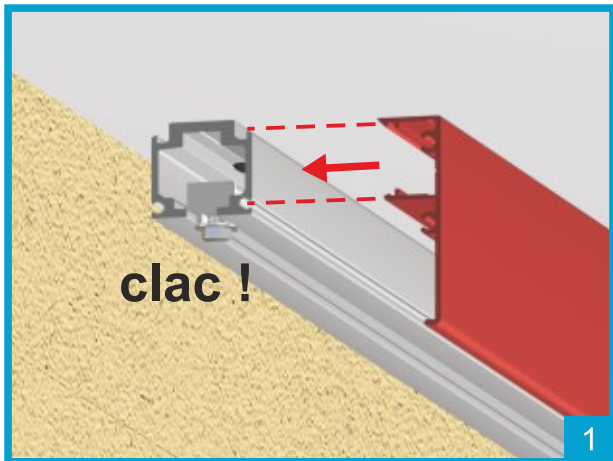



# Pose de la condamnation

Volets 1, 2 ou 3 vantaux repliables

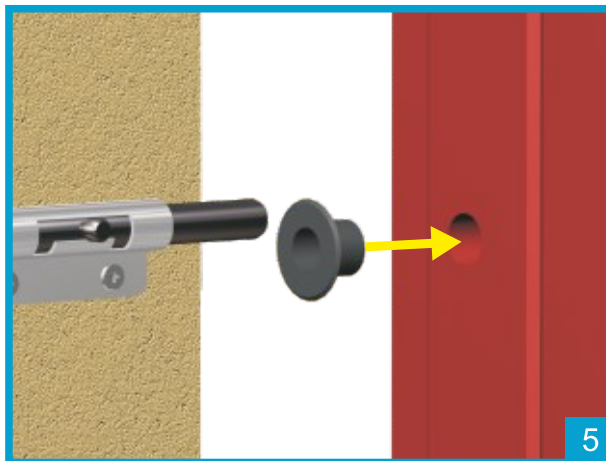
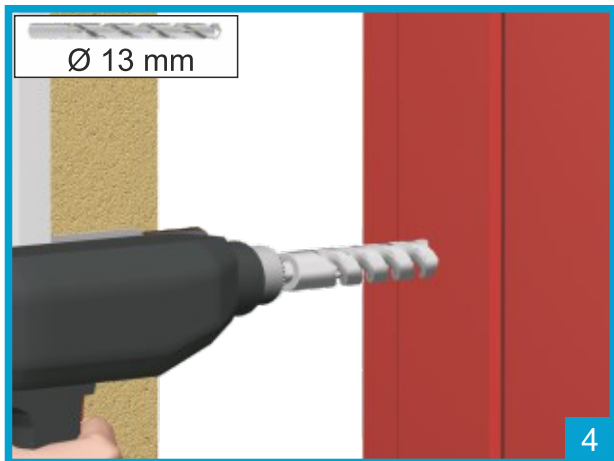
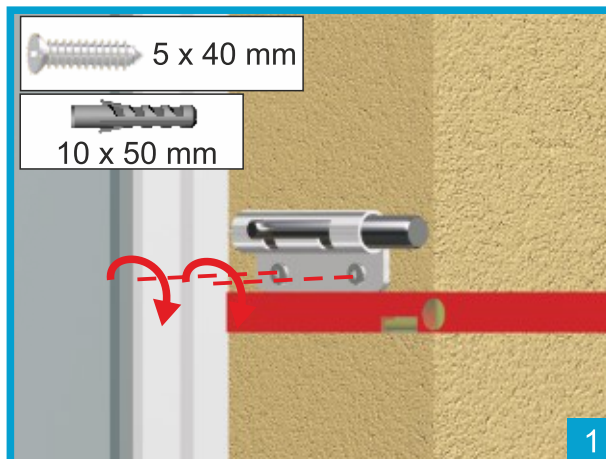

Volets 4 vantaux

